

Fluid End Assembly Accessories

QH-600TWS



QH-600TWS fluid ends are standardized products of our company for matching with the model 600 power ends of fracturing truck produced by several fracturing equipment manufacturers in the world. It is light in weight and easy to install.

Materials performance: In comply with the SAE 4330 V material standards of USA.

Design advantage: Forged SAE 4330V alloy steel, small in size, light in weight, acid and alkali resistance, high pressure resistance, impact resistance and applying to various borehole operations.

Highest under pressure: 16,845 PSI (116.2 MPa).

Maximum flow: 688 gpm.

Application: Acidification treatment, cementing, gravel filling, fracturing work and so on.

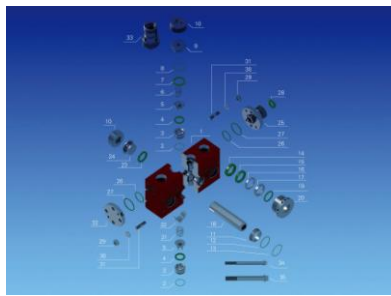

QH-2000TWS



QH-2000TWS fluid ends are standardized products of our company for matching with the model 2000 power ends of fracturing truck produced by several fracturing equipment manufacturers in the world, and it has more than ten years' history in oilfield fracturing operation and it's durable in use.

Materials performance: In comply with the SAE 4330V material standards of USA.

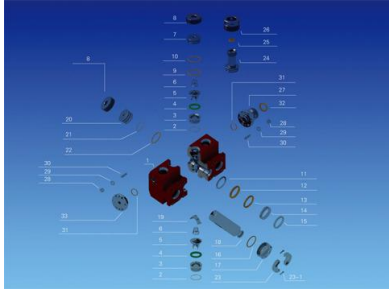

Design advantage: Forged SAE 4330V alloy steel, high pressure resistance, impact resistance.

Highest under pressure: 20000 PSI (137.9 MPa).

Maximum flow: 1226 gpm.

Application: Acidification treatment, high aggregate, high pressure, large displacement and fracturing operation under harsh conditions.

QH-2000HQS



QH-2000HQS fluid ends are standardized products of our company for matching with the imported model HQS-2000 power ends of fracturing truck. It is designed with three-two cylinders jointly and prolongs operating life.

Materials performance: In comply with the SAE 4330V material standards of USA.

Design advantage: Forged SAE 4330V alloy steel, 3+2 conjoined combination, keeping high performance operation under harsh fracturing conditions.

Highest under pressure: 22000 PSI (151.69 MPa).

Maximum flow: 430 gpm.

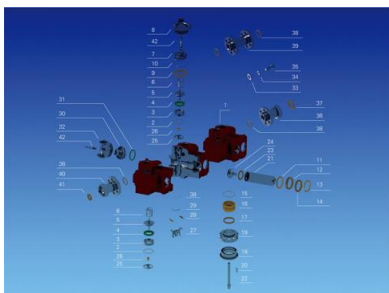

Application: Acidification treatment, high aggregate, high pressure, large displacement and fracturing operation under harsh conditions.

QH-2500QWS



QH-2500QWS fluid ends are standardized products of our company for matching with the model 2000 power ends of fracturing truck produced by several fracturing equipment manufacturers in the world and its advantages are obvious in fracturing operation.

Materials performance: In comply with the SAE 4330V material standards of USA.

Design advantage: Forged SAE 4330V alloy steel, high pressure resistance, impact resistance to extend service life.

Highest under pressure: 25000PSI (172.4 MPa).

Maximum flow: 1894 gpm.

Work strength: Keeping high performance operation 10 hours every day, six days every week under harsh conditions.

Application: Acidification treatment, high aggregate, high pressure, large displacement and fracturing operation under harsh conditions.

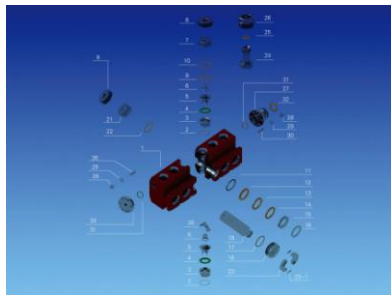

QH-2800QWS



QH-2800QWS fluid ends are standardized products of our company for matching with the model 2800 power ends of fracturing truck produced by several fracturing equipment manufacturers in the world. It has a higher power and more superior performance.

Materials performance: In comply with the SAE 4330V material standards of USA.

Design advantage: Forged SAE 4330V alloy steel, Auto-frettaged design to extend service life, high pressure resistance, impact resistance.

Highest under pressure: 20000 PSI (137.9 Mpa) .

Maximum flow: 1122 gpm.

Work strength: Keeping high performance operation 10 hours every day, six days every week under harsh conditions.

Application: Acidification treatment, high aggregate, high pressure, large displacement and fracturing operation under harsh conditions.

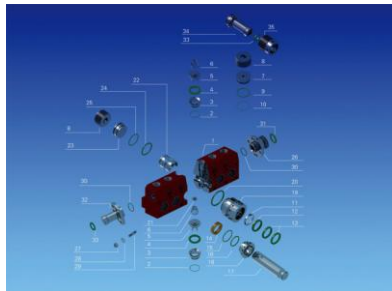

QH-3000TWS



QH-3000TWS fluid ends are standardized products of our company for matching with the SJ-Petroleum fracturing truck power ends

Materials performance: In comply with the SAE 4330V material standards of USA.

Design advantage: Forged SAE 4330V alloy steel, Auto-frettaged design to extend service life, high pressure resistance, impact resistance.

Highest under pressure: 20000 PSI (137.9 Mpa) .

Maximum flow: 848 gpm.

Work strength: Keeping high performance operation 10 hours every day, six days every week under harsh



conditions.

Application: Acidification treatment, high aggregate, high pressure, large displacement and fracturing operation under harsh conditions.

Fluid End Assembly Accessories

<http://www.haimotech.com/Products-and-Services/Fracturing-Equipment-and-Services/Fluid-End-Assembly-Accessories.html>

E-mail: sales@haimotech.com